

Tool Management

with ZCC Cutting Tools Europe



Transparency, efficiency, process optimisation

– EN –



Thorsten Weidhase, Product Manager Tool Management at ZCC Cutting Tools Europe

Potential of integrated tool management in practical application

Integrated tool management offers a number of ways to reduce your costs both directly and indirectly.



- ↳ Reduce costs owing to **fewer number of tools you'll need, automated pooling of requirements** and **elimination of unauthorised removals**
- ↳ Save money thanks to **lower process costs**
 - in the purchasing and procurement of tools;
 - in tool reconditioning;
 - due to the central availability of consistent tool data across all integrated systems and applications, especially with regards to tool planning, configuration and measurement
- ↳ Lower capital costs thanks to **optimised inventories**
- ↳ Cut production costs and cycle times thanks to **reduced machine downtimes** thanks to **ability to forecast availability** of tools, measuring devices and other equipment

The potential savings will vary based on the **individual structures** and the **relative openness to change** in each case. ZCC Cutting Tools Europe analyses and assesses each of these two things, provides advice on each phase in a professional strategy, develops a solution and implements it in close cooperation with you and our partners.

Other potential benefits of tool management

Transparency allows you to tap additional resources in the mapped process chains and by having data and statistics available instantaneously.



- ↳ **continuous improvements** to the processes and how they are managed
- ↳ **improved cost control** overall and in terms of operations, components and batch sizes
- ↳ **weak points identified** immediately
- ↳ constant **monitoring of wear and quality**

Core components of the tool management system

Efficient tool management that is fit for the future should be both modular and implemented in an integrated way. The planning and implementation of interfaces to all current and future systems in the CAD/CAM chain are two of the core requirements for production planning and management in today's world.



▷ Registration



▷ Removal



▷ Use



▷ Filling



Toolbase® dispensing systems

During the implementation phase, ZCC Cutting Tools Europe works together with **Achterberg GmbH**, a company with 30 years of experience in the development and installation of tool management and tool dispensing **solutions** for all relevant types of box, drawer, locker, carousel and electronically controlled systems.

TOOLBASE Advantages of tool dispensing systems:

- ↳ maximum security
- ↳ smart software integration adapted to meet the relevant requirements
- ↳ easy to operate
- ↳ modular design with expansion options
- ↳ availability of tools and other equipment checked constantly
- ↳ lower storage costs and less capital tied up



ATMS CORE basic module

The **Toolbase® ATMS CORE basic module** is installed on every master system. Achterberg GmbH is constantly modifying and upgrading the software to meet new customer requirements.

All modules, including the basic module, monitor to ensure permanent availability and optimal C-parts management. Thanks to the modular software architecture, there are easy and flexible options available to expand and extend the basic module at any time as your needs change.

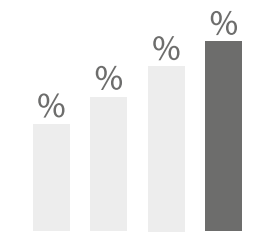
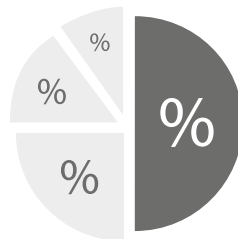
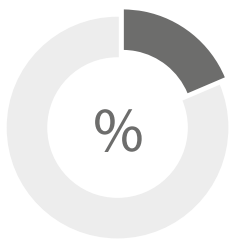

Based on your individual specifications, the smart Toolbase® tool dispensing systems generates **reports on tool use** that can be evaluated, edited and visualised according to a wide range of criteria at defined intervals. **Infographics** make it easier to display and analyse **data**.

Customised solutions

We use tried-and-tested standard components to create a tool management system optimised to meet your specific needs.



The ideal tool management solution for you

The relevant requirements are jointly compiled and documented in the form of requirements and target specifications. These then serve as a basis for making the necessary changes to the software in the master system, selecting the best possible dispenser systems and defining the interfaces for potential system integration.

Advice, support and, if necessary, upgrades are provided on a regular basis after delivery, commissioning, test operation and final acceptance of all components is complete.

'I look forward to hearing from you.'



Thorsten Weidhase
Product Manager Tool Management

Phone: (+49-211) 989240-460
Mobile: (+49-151) 125-26734
E-mail: toolmanagement@zccct-europe.com
Website: www.zccct-europe.com

Scan contact information and
add them to your smartphone:



Notes

Toolbase® dispensing systems

Master systems with integrated software



Toolbase® Control EL-9 Professional with flexible partitioning options

Suitable for small companies

Thanks to the system's electronic locking mechanism and a 33 per cent article control, this automatic tool dispenser offers nine electronic drawers for a wide range of uses, such as the sorting and storage of rotary/cutter holders, solid carbide tools, inserts, measuring devices and spare parts.

Drawer	Height [mm]	Effective depth [mm]	Storage space	Additional information
75*	75	54	4.32 m ²	12x
100	100	79	3.24 m ²	9x
150*	150	129	2.16 m ²	6x
200*	200	179	1.80 m ²	4x + 1x 100 mm

* optional

Technical specifications

Depth:	725 mm
Width:	717 mm
Height:	1.272 mm
Removal:	Automatically controlled
Number of drawers:	9x 100 mm compartment drawers (600x600x79 mm), electronic locking mechanism
Capacity:	Max. 200 kg per drawer



Toolbase® Control EB-60 Professional for any type of application

Suitable for medium-sized companies

The Toolbase® Control EB-60 Professional master system offers an article control of between 80–90 per cent thanks to its 4x15 heavy-duty plastic boxes. The system is splendidly simple and ideal for storing solid carbide tools, inserts and spare parts.

Box	Width [mm]	Depth [mm]	Height [mm]	Number of compartments per box	Storage space
EB-60	145	375	55	max. eight compartments	3.26 m ²

Technical specifications

Depth:	725 mm
Width:	717 mm
Height:	1.272 mm
Removal:	Automatically controlled
Number of boxes:	60, electronic locking mechanism
Capacity:	max. 5 kg per box

Toolbase® dispensing systems

Master systems with integrated software



Toolbase® Control AR-19 600 Professional for bulk items (also available as an extension unit; see page 11)

[Suitable for large companies](#)

With 19 levels, Toolbase® Control AR-19 600 Professional is specially designed for storing solid carbide tools, inserts and personal protection articles. The system offers a maximum capacity of 600 kg, ensuring high-quality bulk items are optimally stored and giving you a 100 per cent article control.

Compartment size	Number of compartments	No. of compartments/levels	Max. number of levels	A [mm]	B [mm]	C [mm]	D [mm]	Max. capacity/compartment (kg)
1	1.140	60	19	80	45	316	12	3
2	760	40	19	80	68	316	32	3
3	380	20	19	80	136	316	51	3
4	540	60	9	160	45	316	12	3
5	360	40	9	160	68	316	32	3
6	180	20	9	160	136	316	51	3

Technical specifications

Depth:	1.025 mm
Width:	985 mm
Height:	1.980 mm
Removal:	Individual removal, automatically controlled
Number of compartments:	200–1140 (depending on configuration)
Tare weight/payload:	695 kg/max. 600 kg per drawer (depending on configuration)

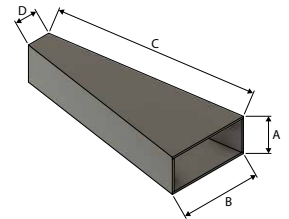

Toolbase® dispensing systems

Slave systems with flexible integration options



Toolbase® EL-12 Professional

Extension unit with max. 200 kg per drawer

The 12 drawers in the Toolbase® EL-12 system can be customised on demand. High-quality materials can be stored in (optional) individually lockable flaps that offer a 33 per cent article control.

Drawers	Height [mm]	Effective depth [mm]	Storage space	Additional information
75	75	54	4.32 m ²	6+6
100	100	79		
75*	75	54	**	***
100*	100	79	**	***
150*	150	129	**	***
200*	200	179	**	***

* optional/available on demand ** depending on drawer combination, *** depending on drawer combination (max. 1.050 mm)

Technical specifications

Depth:	725 mm
Width:	717 mm
Height:	1.272 mm
Removal:	Automatically controlled
Number of drawers (standard):	6x 75 mm drawers (600×600×54 mm), electronic locking mechanism 6x 100 mm drawers (600×600×79 mm), electronic locking mechanism
Capacity:	Max. 200 kg per drawer



Toolbase® EL-56 Professional

Extension unit with max. 20 kg per drawer

The high-quality, rail-guided 4×14 drawers available with the Toolbase® Control EL-56 system ensure the tools you store in it are protected against unauthorised access. Other advantages include ease of use and a 90 per cent article control. The individual drawers provide space for storing solid carbide tools, inserts and PPE articles.

Box	Width [mm]	Depth [mm]	Height [mm]	Number of compartments per box	Storage space
EB-56	125	612	75	max. 18 compartments	3.86 m ²

Technical specifications

Depth:	725 mm
Width:	717 mm
Height:	1.272 mm
Removal:	Automatically controlled
Number of drawers:	56, electronic locking mechanism
Capacity:	Max. 20 kg per box

Toolbase® dispensing systems

Slave systems with flexible integration options



Toolbase® EB-33-EB-76 Professional Expansion unit (available in different sizes)

The sturdy plastic boxes are available in a number of sizes with the Toolbase® EB system, making them ideal for storing rotary/cutter holders, solid carbide tools and inserts. Because the system is so easy to use, you can choose the exact tool you need and take it out. Article control of up to 90 per cent is possible.

Boxes	Width [mm]	Depth [mm]	Height [mm]	Number of compartments per box	Storage space
EB-60	145	375	55	max. eight compartments	3.26 m ²
EB-76	145	375	55	max. eight compartments	4.13 m ²
EB-33	226	450	105	max. ten compartments	3.36 m ²
EB-44	142	470	105	max. ten compartments	2.94 m ²

Technical specifications	EB-60	EB-76	EB-33	EB-44
Depth:	725 mm	725 mm	725 mm	725 mm
Width:	723 mm	723 mm	807 mm	731 mm
Height:	1.272 mm	1.550 mm	1.550 mm	1.550 mm
Removal:	Automatically controlled			
Number of boxes:	60	76	33	44
Locking:	Individual, electronic locking mechanism			
Capacity per box:	Max. 5 kg	Max. 5 kg	Max. 7.5 kg	Max. 7.5 kg



Toolbase® ES-40L Professional Expansion unit with integrated power connection

The Toolbase ES-40 L Professional locker system is ideal for dispensing bulky or high-volume items such as rotary/cutter holders, PPE articles and measuring equipment. The system can be upgraded to include an integrated 220 V power connection to ensure that electric hand tools are always charged. An article control of 100 per cent is guaranteed.

Compartment size	Max. number of compartments	A [mm]	B [mm]	C [mm]	Additional information
1 (1x RU)	40	380	585	80	—
2 (2x RU)	20	380	585	170	—
3 (1x RU)	12	380	585	260	Plus 4x compartment 1 or 2x compartment 2
4 (1x RU)	10	380	585	350	—

Technical specifications	
Depth:	600 mm
Width:	1.020 mm
Height:	1.940 mm
Removal:	Automatically controlled
Number of compartments:	10–40, varies based on selected compartment size
Capacity:	Max. 15 kg when evenly loaded

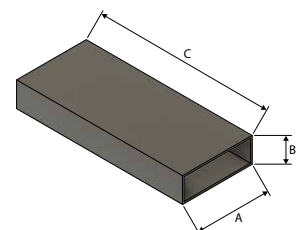

Toolbase® dispensing systems

Slave systems with flexible integration options



Toolbase® EV-4 Professional Extension unit with vertical drawers

Toolbase® EV-4 Professional is an automatic dispenser for rotary and cutter holders designed to provide secure storage of assembled tools. The drawers can be used from both sides, allowing efficient use day in, day out.

EV-4 Professional is highly flexible thanks to its modular design. The space inside the system can be configured based on the user's specific needs. In addition, connection options are integrated into the system to make it possible to store as many different tools as possible.

Technical specifications

Depth:	757 mm
Width:	1.000 mm
Height:	1.950 mm
Effective depth:	1.849 mm
Number of drawers:	Four vertical drawers
Number of adjustable shelves:	Four per vertical drawer
Grid:	50 mm, height adjustable
Locking:	Vertical drawers locked individually, electronic locking mechanism
Capacity per drawer:	200 kg



Toolbase® AR-19 600 Professional Extension unit for bulk items

With 19 levels, Toolbase® Control AR-19 600 Professional is specially designed for storing solid carbide tools, inserts and personal protection articles. The system offers a maximum capacity of 600 kg, ensuring high-quality bulk items are optimally stored. In addition to that, it also offers a 100 per cent article control.

Compartment size	Number of compartments	No. of compartments/levels	Max. number of levels	A [mm]	B [mm]	C [mm]	D [mm]	Max. capacity/compartment (kg)
1	1.140	60	19	80	45	316	12	3
2	760	40	19	80	68	316	32	3
3	380	20	19	80	136	316	51	3
4	540	60	9	160	45	316	12	3
5	360	40	9	160	68	316	32	3
6	180	20	9	160	136	316	51	3

Technical specifications

Depth:	1.025 mm
Width:	985 mm
Height:	1.980 mm
Removal:	Individual removal, automatically controlled
Number of compartments:	200–1140 (depending on configuration)
Tare weight/payload:	695 kg/max. 600 kg per drawer (depending on configuration)

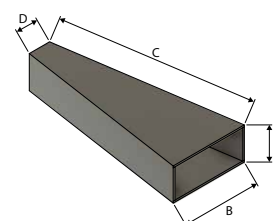



Scan for PDF

Tool Management

Transparency, efficiency, process optimisation



116 | TM | v1.1 | 1.0 | 12.24

European Headquarters

ZCC Cutting Tools Europe GmbH

www.zccct-europe.com

Wanheimer Str. 57, 40472 Düsseldorf, Germany

Phone: (+49-211) 989240-0

Fax: (+49-211) 989240-111

E-mail: info@zccct-europe.com

Branch office France

ZCC Cutting Tools Europe GmbH Succursale Française

www.zccct-europe.com

14, Allée Charles Pathé, 18000 Bourges, France

Phone: +33 (0) 2 45 41 01 40

Fax: +33 (0) 800 74 27 27

E-mail: ventes@zccct-europe.com

Branch Office UK

ZCC Cutting Tools Europe GmbH UK Division

www.zccct-europe.com

4200 Waterside Centre, Solihull Parkway

Birmingham Business Park

Birmingham, West Midlands, B37 7YN, UK

Phone: +44 (0) 121 8095469

Fax: (+49-211) 989240-111

E-mail: infouk@zccct-europe.com



© Copyright by ZCC Cutting Tools Europe GmbH

All rights reserved. All descriptions and illustrations are protected by copyright. The use, modification and reproduction, in whole or in part, without written permission are prohibited. We reserve the right to make technical modifications and changes to the product range. No liability for misprints and errors.